

SEPTEMBER 2005 • VOL. 5, NO. 4

HEALTHCARE DESIGN



Architectural Showcase Issue

VENDOME GROUP, LLC—MEDQUEST DIVISION, IN CONJUNCTION WITH

THE CENTER FOR
HEALTH DESIGN

ARCHITECTURAL SHOWCASE

HEART INSTITUTE

Wilmot/Sanz, Inc. GAITHERSBURG, MD

Christiana Hospital NEWARK, DE

The Christiana Hospital campus expansion will create an integrated Cardiac and Vascular Center of Excellence and provide additional beds needed through the end of this decade, while enhancing education capabilities for staff and the community.

The new clinical care and education initiative for the Christiana Health System will add 172 private inpatient beds that can flex to 204 beds at peak census and will expand Christiana Care's cardiovascular program with an integrated suite of Cardiac and Vascular interventional rooms. It will also establish a state-of-the-science education conference center.

Construction of the two-phase project is expected to be finished in the fall of 2006. The first phase added a cardiovascular interventional suite; the second phase, begun in the summer of 2004, will add a new 172-bed cardiac and vascular patient tower and a new education conference center.

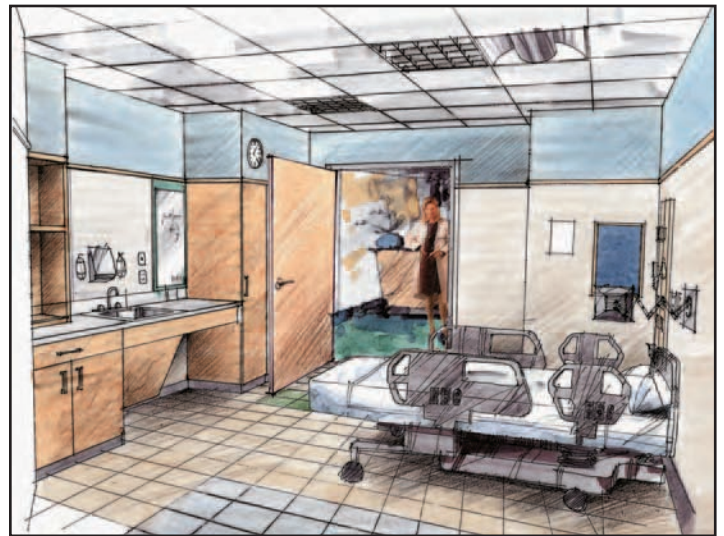
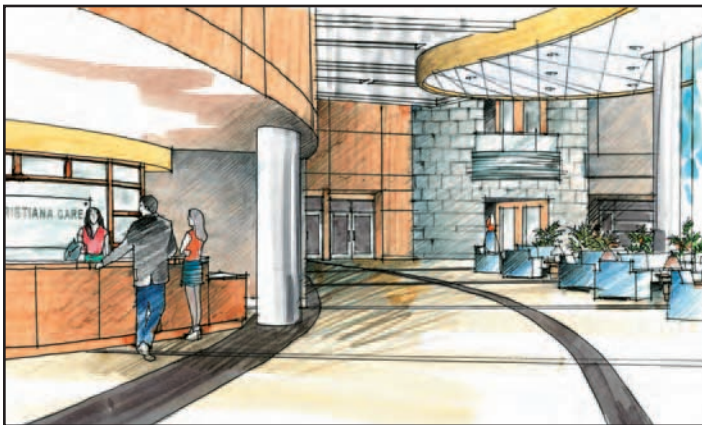

Project category: Project in progress (September 2006)

Chief administrator: Gary Furgeson, Chief Operating Officer, (302) 733-1274

Firm: Wilmot/Sanz, Inc., (301) 590-2900

Design team: Craig Moskowitz, AIA, Principal-in-Charge; Dwight Fincher, Hui Du, and Yiling Mackay, Architectural Design Team; Sheila Williams, Project Architect

Total building area (sq. ft.): 340,000

Construction cost/sq. ft.: \$213

Total construction cost (excluding land): \$72,400,000